

PolarTech 63mm

Motorized

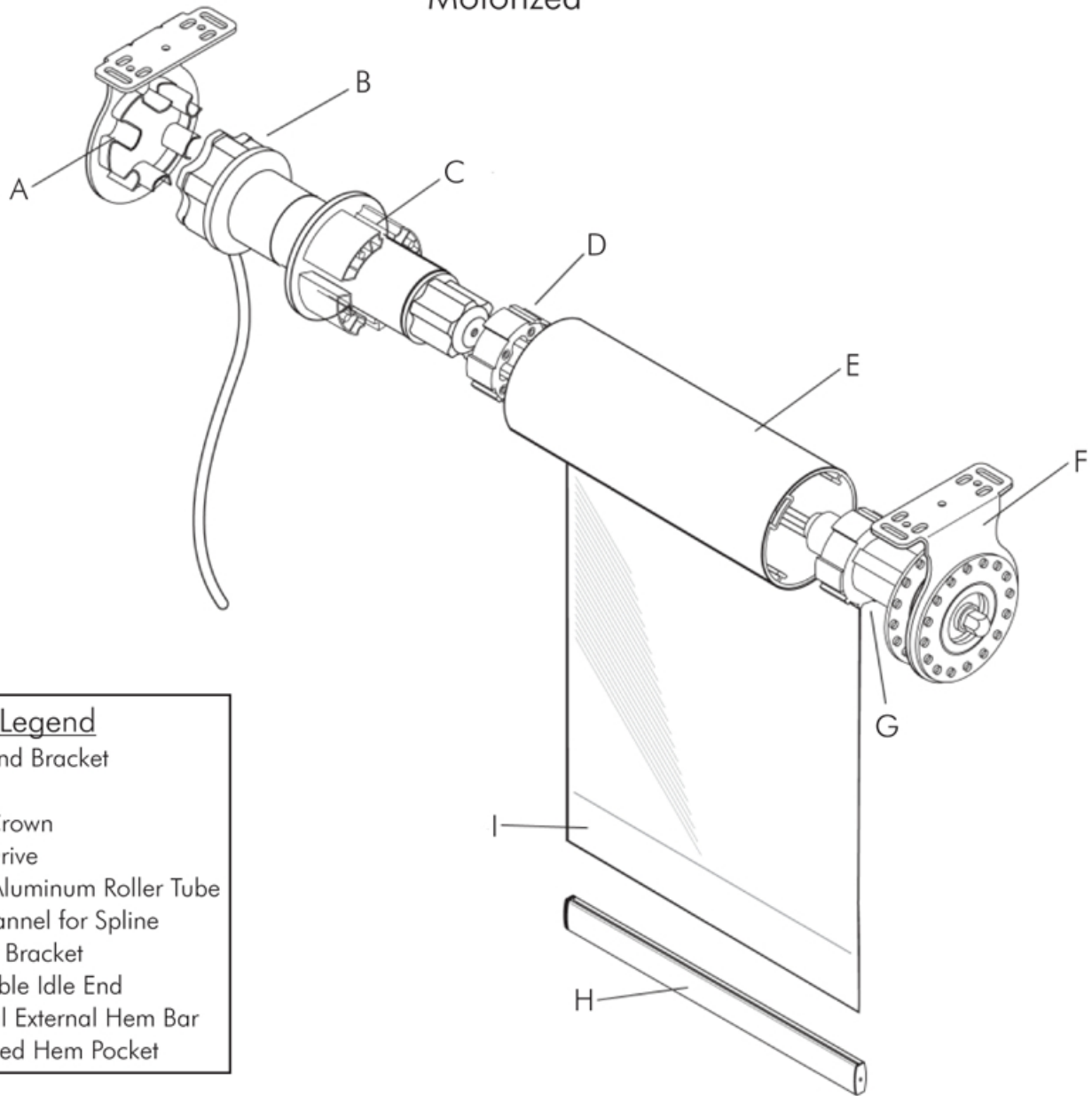

Legend

- A - Motor End Bracket
- B - Motor
- C - Motor Crown
- D - Motor Drive
- E - 63mm Aluminum Roller Tube with Channel for Spline
- F - Idle End Bracket
- G - Retractable Idle End
- H - Optional External Hem Bar
- I - RF Welded Hem Pocket

- ⊗ A line voltage AC motor is used to raise and lower the shade.
- ⊗ All motors come standard with a 6' pigtail. Additional plugs are available.
- ⊗ Standard roller tube is 63mm extruded aluminum with a channel to accept fabric spline making the shade panel easy to remove.
- ⊗ Optional adjustable idle end bracket allows shades to be leveled while in place.
- ⊗ Internal Hem Bar sealed in RF Welded Hem Pocket. Optional External Hem Bar is available.
- ⊗ Edge gap is 7/8" on the motor end and 7/8" on the retractable idler end.
- ⊗ Standard precision bearings for quiet operation are standard.