

PolarTech 8

Manual

Roller Shade System for Room Darkening Applications

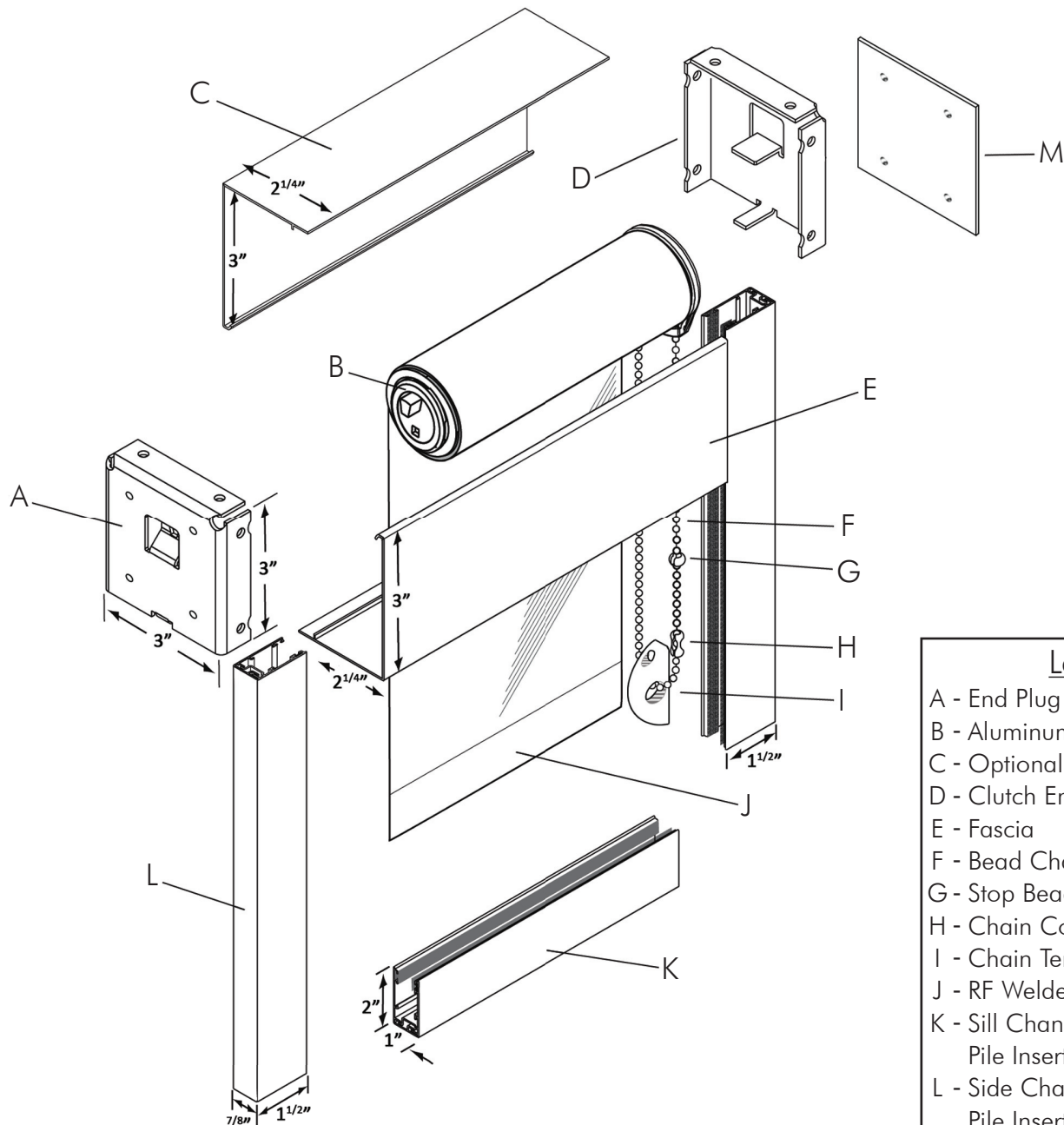

Legend

- A - End Plug Fascia Bracket
- B - Aluminum Roller Tube
- C - Optional Back Fascia
- D - Clutch End Fascia Bracket
- E - Fascia
- F - Bead Chain
- G - Stop Bead
- H - Chain Connector
- I - Chain Tensioner
- J - RF Welded Hem Pocket
- K - Sill Channel with Synthetic Pile Insert
- L - Side Channel with Synthetic Pile Insert
- M - End Cap

- ☼ Clutch Lift System has an up to eight pound lifting capacity.
- ☼ Shades are raised and lowered by means of a continuous loop bead chain.
- ☼ The Hem Bar will be extruded aluminum and completely enclosed in a RF Welded Hem Pocket. Optional External Hem Bar available.
- ☼ Fascia measures 3" high with a 2-1/4" bottom lip and snaps onto 3" x 3" fascia bracket. Available in white, tan, clear anodized, bronze or black.
- ☼ Side and sill channels are extruded aluminum with synthetic pile inserts to eliminate light leakage. Available in white, tan, clear anodized, bronze or black.
- ☼ Optional spring assist reduces pull force allowing easy lifting of larger shades.

Out with the old. In with the View!

877-260-6110

POLAR SHADES®
sun control

polarshade.com

5520 Stephanie Street • Las Vegas, NV 89122 • info@polarshade.com