

PolarTech Interior Shade

Motorized

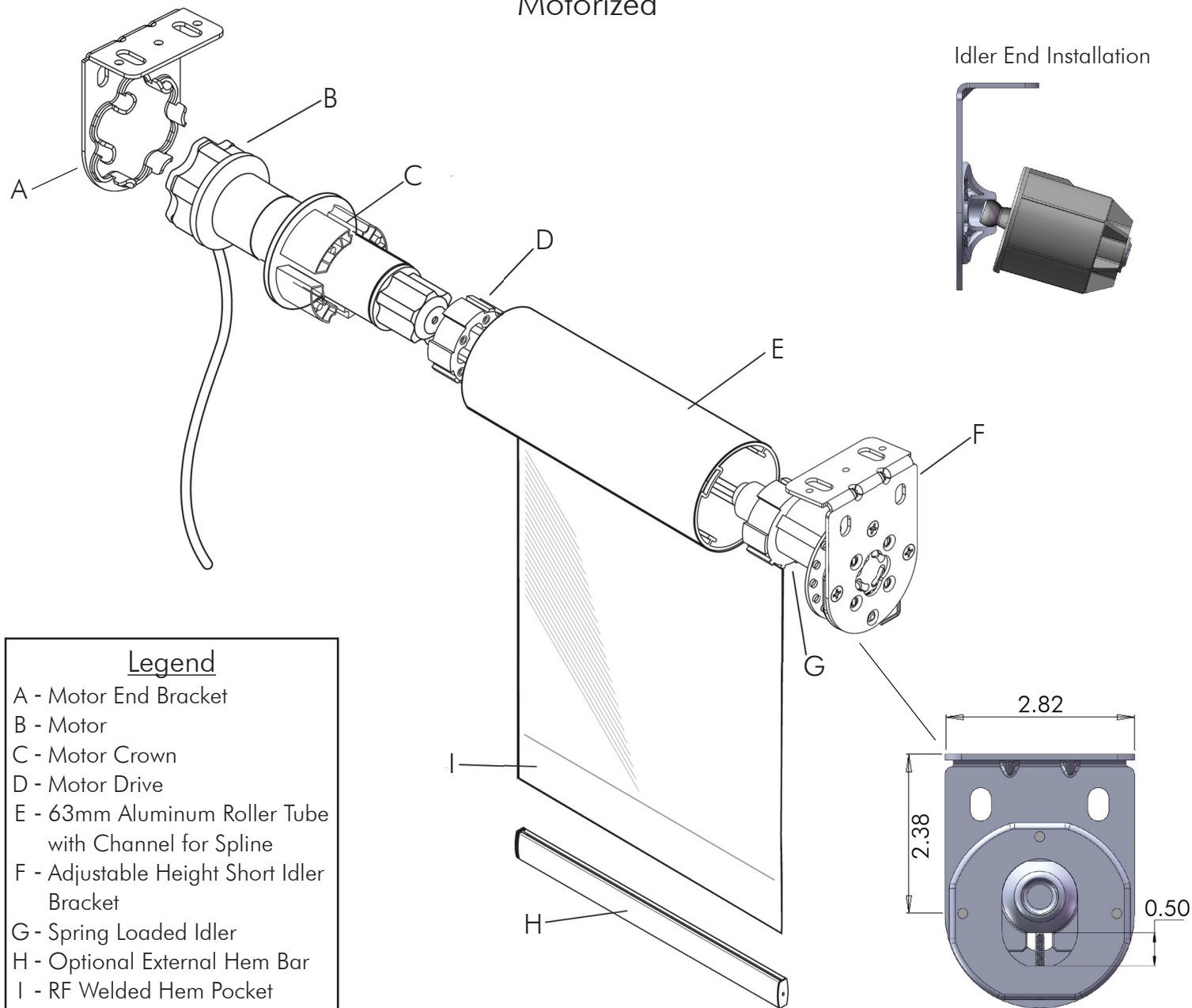

- ☼ A line voltage AC motor is used to raise and lower the shade.
- ☼ All motors come standard with a 6' pigtail. Additional plugs are available.
- ☼ Standard roller tube is 63mm extruded aluminum with a channel to accept fabric spline making the shade panel easy to remove.
- ☼ Adjustable idle end bracket allows shades to be leveled while in place.
- ☼ Internal Hem Bar sealed in RF Welded Hem Pocket. Optional External Hem Bar is available.
- ☼ Edge gap is 7/8" on the motor end and 7/8" on the retractable idler end.
- ☼ Standard precision bearings for quiet operation are standard.

Out with the old, In with the View!

877-260-6110

POLAR SHADES®
sun control

polarshade.com

5520 Stephanie Street • Las Vegas, NV 89122 • info@polarshade.com